



Breaking Ground with Blueprint for Learning

From classrooms and conference rooms to libraries and theaters, Remake Learning's Blueprint of Learning grantees are unveiling their plans for fun, funky, and student-centered learning spaces.



A Quick Recap...

Remake Learning launched the **Blueprint for Learning grant opportunity** in summer 2019 to help schools and organizations across the region redesign their spaces to better engage 21st-century learners.

After receiving over 100 applications, the Blueprint for Learning review team selected 16 finalists for funding. Each finalist organized a comprehensive design team, including faculty/staff from various levels of their organization, local architects, and design professionals. In many cases, design

teams also incorporated feedback from students, families, and community members.

Design teams convened with Remake Learning, the National Design Alliance, and **Reimagine America's Schools** in fall 2019. They attended a series of design sessions, working collaboratively to craft their final design plans.

Last November, teams submitted their plans for funding. Each received \$50,000 to support their project, and today, we're excited to share the first glimpse of their projects with you.

Building A Foundation for Peer Learning

In addition to *creating* modern, student-centered spaces, Remake Learning challenged the Blueprint for Learning cohort to explore collaborative ways of *using* their redesigned spaces.

Each project has considered how their spaces might serve as a hub for professional development, continued learning, or community engagement, and are working to develop related community-based programming.

Read more on for more, and prepare for some serious design-envy and inspiration!

Jump to: Allegheny Valley School District, Attack Theatre, B.F. Jones Memorial Library, Bible Center Church, Boys & Girls Clubs of Western Pennsylvania, The Campus Laboratory School of Carlow University, Center that C.A.R.E.S, Senator John Heinz History Center, Hope Academy, Human Services Center Corporation, North Elementary School, Brashear High School, Providence Connections, Verner Elementary School, Western Pennsylvania School for the Deaf, Wheeling Country Day School

Allegheny Valley School District

THE CURRENT SPACE

Underutilized conference room

THE VISION

A student-designed learning lab that integrates with multiple adjacent spaces, helping to grow class offerings, district programming, and the value of student voice

HIGHLIGHTS FROM THE BLUEPRINT

- A "classroom of the future," adaptable to a variety of uses by a variety of users
- Student-run cafe and store
- Student de-stress zone

PEER LEARNING PLAN

The reimagined space will be open to community-based adult learning, including classes for parents and programs/workshops hosted by local municipalities and organizations, plus region-wide professional development for educators.



Current space

Current space

Design plan

Attack Theatre

THE CURRENT SPACE

Blank-slate building

THE VISION

An inclusive, open, and flexible performance space that kickstarts Attack Theatre's new permanent home, engages the local community, supports the local arts culture, and showcases the importance of dance, kinesthetic learning, and arts enrichment

HIGHLIGHTS FROM THE BLUEPRINT

- Updated facade and outdoor signage
- Entrance with a "wow-factor"
- Adjustable walls and cabinetry to help create a multi-functional space
- Cozy, backstage hangout zone

PEER LEARNING PLAN

During their first year of operation, the Theatre plans to host multiple professional development sessions as well as local educator convenings.

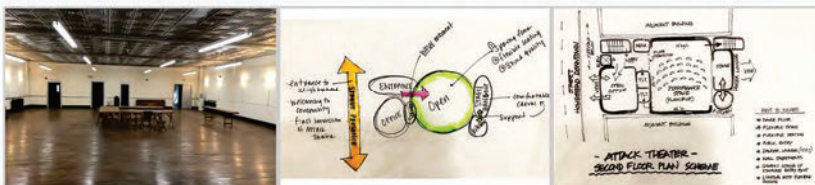

Current space

Design plan

Design plan

B.F. Jones Memorial Library

THE CURRENT SPACE

Dark welcome center; unexciting reading and story rooms

THE VISION

Three interconnected spaces with a natural flow, plus room for kids and adults alike to explore and discover a passion for life-long learning

HIGHLIGHTS FROM THE BLUEPRINT

- Special areas defined by carpet
- Feature walls in each space
- Flexible and movable amphitheater seating
- Multi-monitor video displays

PEER LEARNING PLAN

The library will host networking events, Remake Learning Days events, community open houses, and

other community programming in their remade spaces.



Current space

Current space

Current space



Design plan

Design plan

Inspiration image

Bible Center Church

THE CURRENT SPACE

Harsh hardscape

THE VISION

An outdoor pre-k classroom that teaches community youth about botany and agriculture, celebrates culture and ethnicity, promotes positive racial identity in students of color, and inspires support for further funding

HIGHLIGHTS FROM THE BLUEPRINT

- Repaired existing structures, including sidewalks, retaining walls, and floating bench
- Large-scale, inspirational art installation
- Exhibit-style information displays
- Wall-mounted interactive displays

PEER LEARNING PLAN

In addition to students enrolled in the Bible Center Church's pre-k class, the classroom will serve as a community learning space for children of parents enrolled at the **Community College of Allegheny County** and those enrolled in classes associated with other programs at Bible Center Church and **The Oasis Project**.

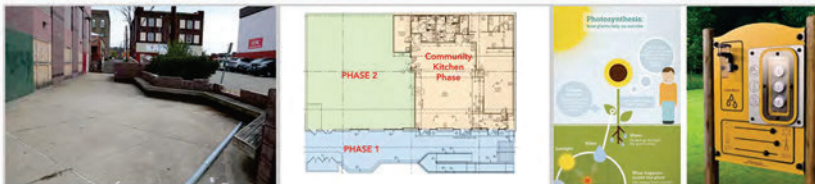

Current space

Design plan

Inspiration image

Boys & Girls Clubs of Western Pennsylvania

THE CURRENT SPACE

Aging game room

THE VISION

A *maker lab* that *can grow with learners* and help cultivate a new organizational culture

HIGHLIGHTS FROM THE BLUEPRINT

- Creative and high-tech vibe
- Ceiling power reels

- Brainstorming spaces, collaboration areas, and activity zones, with visibility between all spaces to encourage "learning on display"

PEER LEARNING PLAN

The remade maker lab will give educators and learners from around the region an environment in which to share and host trainings, guest speakers, and field trips.



Current space

Current space

Current space

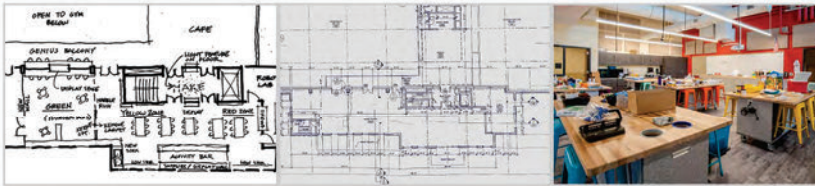

Design plan

Design plan

Inspiration image

The Campus Laboratory School of Carlow University

THE CURRENT SPACE

Inflexible first-floor library

THE VISION

A dynamic student hub, designed for discovery, collaboration, and literacy, capable of engaging learners of multiple ages

HIGHLIGHTS FROM THE BLUEPRINT

- Bright, welcoming, and modern touches that maintain and incorporate the space's historical elements
- Multiple centers of activity for reading story-telling, gaming, writing, and tinkering

PEER LEARNING PLAN

The library will provide space for parents and Carlow University students to meet and collaborate. It will also serve as a homebase for future summer, afterschool, and evening programming for members of the surrounding Oakland and Hill District communities.



Current space

Current space

Design plan



Inspiration image

Inspiration image

Inspiration image

Center that C.A.R.E.S

THE CURRENT SPACE

THE VISION

A modern learning center that engages students in creative thinking, collaborative learning, and connectivity, and helps prepare youth for the future workplace

HIGHLIGHTS FROM THE BLUEPRINT

- Bright colors extending throughout the space, including to furniture and finishes
- Organized, task-based activity zones
- Maker space with both high- and low-tech resources
- Global learning technology

PEER LEARNING PLAN

The newly redesigned learning center will host student peer learning events and parent open houses.

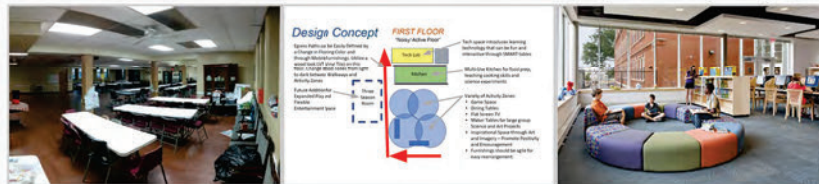

Current space

Design plan

Inspiration image

Senator John Heinz History Center

THE CURRENT SPACE

"Meh" multipurpose room

THE VISION

A flexible, dividable learning space bursting with visual interest and filled with active, kid-friendly furniture

HIGHLIGHTS FROM THE BLUEPRINT

- New sink and plumbing system with access to non-potable water for clean-up use
- Stripe floor with pattern
- Engaging wall graphics

PEER LEARNING PLAN

The redesigned space will be the new home for the center's three to five annual teacher professional development workshops designed for regional K-12 classroom teachers. Workshops will focus on social studies and interdisciplinary connections with language arts, art, geography, and media literacy.



Current space

Current space

Design plan



Inspiration image

Inspiration image

Inspiration image

Hope Academy

THE CURRENT SPACE

The inbetweeners: Ground floor lobby and corridors

THE VISION

A fully activated, connected, and supportive space, where parents and siblings of students don't just wait, but make, read, and learn

HIGHLIGHTS FROM THE BLUEPRINT

- Tented, cozy "quiet zone" for kids
- Improved unpacking area for parents and families
- Plenty of new seating

PEER LEARNING PLAN

In addition to engaging students, families, and teaching artists connected to Hope Academy, the redesigned space will host the greater Pittsburgh Suzuki learning community for an annual Suzuki Fall Workshop.

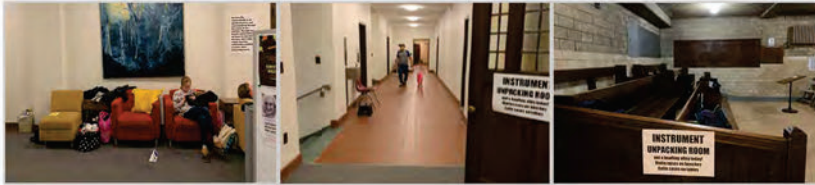

Current space

Current space

Current space



Design plan

Inspiration image

Inspiration image

Human Services Center Corporation (HSCC)

THE CURRENT SPACE

Corporate classroom

THE VISION

An inviting, non-institutional, and easily adaptable learning hub that accommodates multiple learning and social activities and provides options for controlling acoustics, light, and distractions

HIGHLIGHTS FROM THE BLUEPRINT

- Acoustic ceiling and wall panels
- Use of floor lamps and area rugs to create a welcoming, non-classroom feel
- Use of color that empowers and inspires
- Former storage closets transformed into bench seating

PEER LEARNING PLAN

HSCC plans to host peer-learning meetings of their Mon Valley Providers Council, plus external speakers, professional development events, and lunch & learn events.



Current space

Current space

Current space

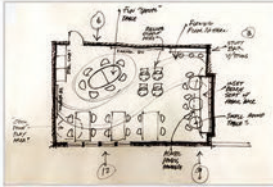

Design concept

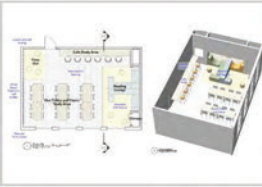

Design plan



Inspiration image

Monongalia County Schools, North Elementary School

THE CURRENT SPACE

Overgrown greenspace

THE VISION

Functional, accessible, and inquiry-based outdoor learning environment, enabling students to learn about the world around them while gardening, exploring nature, and problem-solving

HIGHLIGHTS FROM THE BLUEPRINT

- Use of reused and recycled materials
- Areas for composting and rain collection
- Lush gardens that learners to explore through organized pathways and learning stations
- A "Live Wall" of plants and greenery

PEER LEARNING PLAN

North Elementary's reborn garden will help them continue to lead the way in garden-based learning. They will help other school districts develop garden-based curriculums and invite community members, including master gardeners, to host public events in the garden.



Current space

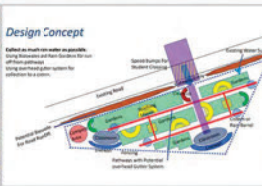

Design plan



Inspiration image

Pittsburgh Public Schools, Brashear High School

THE CURRENT SPACE

Worn, dated school library

THE VISION

Contemporary media center that supports the culture and vibrancy of the school's diverse student population, while furthering next-generation learning objectives

HIGHLIGHTS FROM THE BLUEPRINT

- Lively entry area with transparent doors and graphics
- Lounge zone with fresh furniture
- Freestanding tall stacks removed and replaced with low stacks

The media center will open its doors to students, classes, clubs, and community groups.

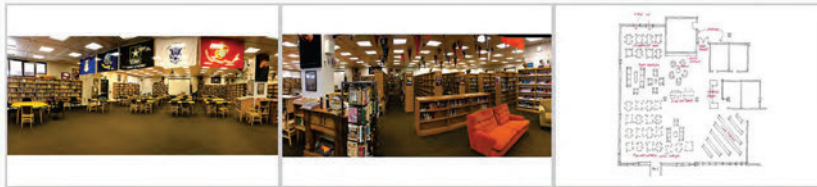

Current space

Current space

Design plan



Inspiration image

Inspiration image

Inspiration image

Providence Connections

THE CURRENT SPACE

Maker space with potential for more

THE VISION

A rooftop deck, designed for outdoor STEAM learning

HIGHLIGHTS FROM THE BLUEPRINT

- A tranquil, enriching environment connecting students to the outdoors and nature
- Multiple activity areas, for making, horticulture, yoga, stargazing, and more

PEER LEARNING PLAN

Providence's childcare classrooms will visit the outdoor classroom for maker projects and STEAM learning lessons. Family support staff may use the space to host supervised visits in a calming environment, or host wellness events for parents and guardians in need of reprieve. Staff will also utilize the room as a creative co-working space.



Current space

Current space

Inspiration image

Riverview School District, Verner Elementary School

THE CURRENT SPACE

Separate library spaces

THE VISION

A reimagined "Creativity Lab," focused on technology and STEM exploration, and a "Curiosity Lab," comprising a new makerspace for hands-on application of math and science concepts

HIGHLIGHTS FROM THE BLUEPRINT

- Green screen area
- Writable wall and table surfaces

- An operable glass wall between the Curiosity Lab and the library, plus an extra “secret entrance” to the space

PEER LEARNING PLAN

The labs will welcome students, teachers, families of students, and members of the parent-teacher organization for events or academic implementation, along with mental health professionals, community members, and other learners.



Current space

Current space

Current space

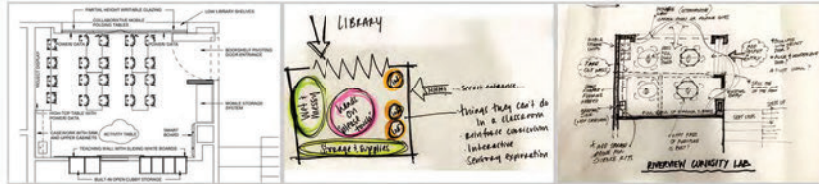

Design plan

Design plan

Design plan

Western Pennsylvania School for Deaf (WPSD)

THE CURRENT SPACE

Crowded computer classroom

THE VISION

A deaf-friendly classroom environment that addresses the parameters of **Deaf Space**—less furniture, more communal space, room for collaboration, mobility of equipment, free movement, and visual access—and provides for enhanced communication and development of Next Generation skills

HIGHLIGHTS FROM THE BLUEPRINT

- Angled walls to assist with acoustics
- Work stations with integrated, interactive tech
- A defined central instructor area, to promote visual access for all students

PEER LEARNING PLAN

In addition to on-site WPSD students and teachers, the classroom will serve teachers and administrators from Scranton, Edinboro, and Hershey, teachers at local public schools, and teachers from other Deaf schools across the country through professional development opportunities.

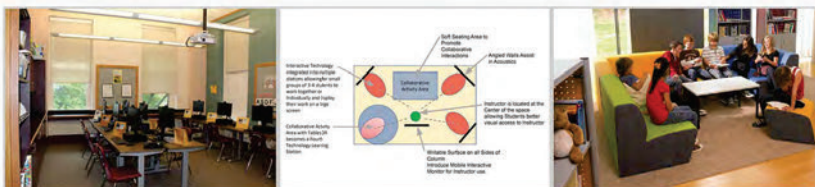

Current space

Design plan

Inspiration image

Wheeling Country Day School (WCDS)

THE CURRENT SPACE

Dingy early-childhood library

THE VISION

An engaging, dynamic indoor-outdoor learning space that has a modern aesthetic and inspires a sense of wonder

- Smartly repurposed materials
- New colorful and patterned carpet to enliven the space
- New outdoor shade structure that extends the library outdoors

PEER LEARNING PLAN

WCDS students, teachers, parents, and affinity groups, plus numerous community stakeholders, will utilize the redesigned library for class instruction, peer professional development, summer camps, speaker events, and other community events.



Current space

Inspiration image

Inspiration image

Blueprint for Learning is generously supported by the Claude Worthington Benedum Foundation, The Grable Foundation, and the Hillman Foundation.